



Scan to activate a one-year warranty

Marauder's Map Keyboard Case for iPad

Manual

Connection Settings

Turn on the power of the keyboard,
press “fn + C” to enter pairing mode

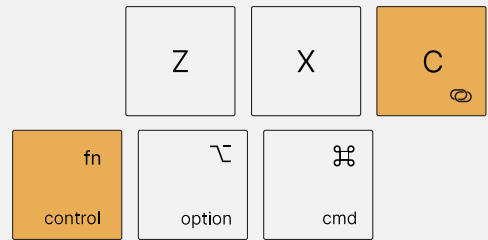

Go to **Settings**, then press **Bluetooth**



Settings

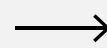

Bluetooth

Search for “**Marauder's Map**”,
and connect with iPad

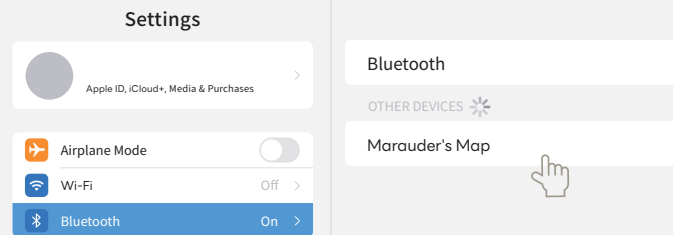

It will show “**Connected**”
once it is connected

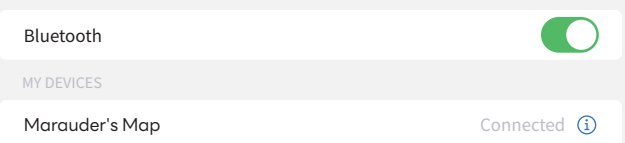

First-time Setting

Way to open the keyboard:

Since the iPad relies on back magnetic attraction, when opening the keyboard, **please hold the iPad in the middle** and unfold it upwards. If unfolded from the left/right corners, it may cause an asymmetric magnetic force, please be careful.

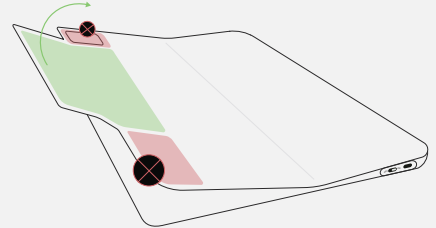

Language Switching (Press the “🌐” key to **switch language**)

Turn off “Press 🌐 for Emoji”

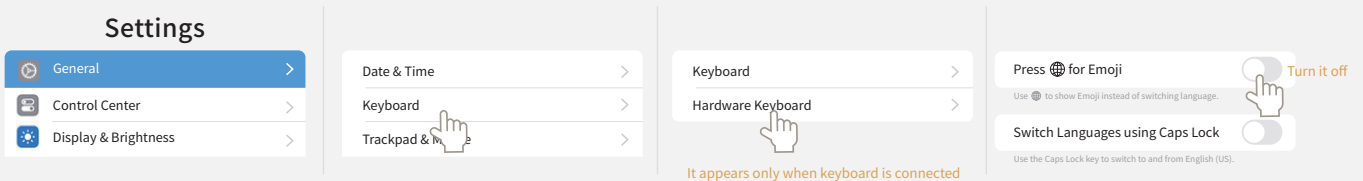

** Besides pressing “🌐”, you could press “Control + Spacebar” to switch language as well.

Caps Lock Setting

Due to the default setting on iPad system, Caps Lock key on the keyboard does not capitalize any letter until the setting is changed as shown below. Once **the “Switch languages using Caps Lock” is off**, **Caps Lock can then be used** to toggle between uppercase and lowercase letters just like on a computer keyboard.

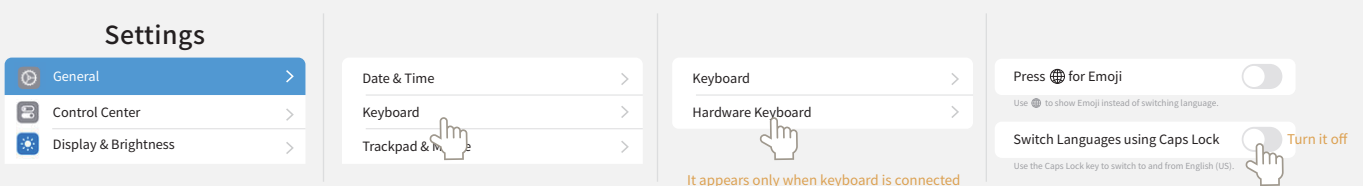

Shortcut Key

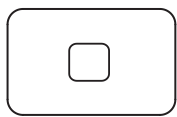

Homepage

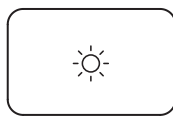

Brightness
Decrease

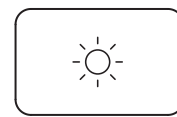

Brightness
Increase

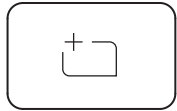

Screenshot

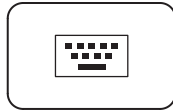

Virtual
Keyboard

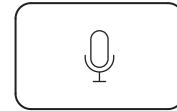

Siri

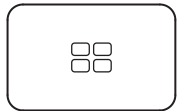

App Switcher



Volume Down



Volume Up



Lock Screen
(Hold for 2 sec)

Stylus Shortcut:

The current stylus shortcut keys only support Goodnotes and Notability.



Pen



Highlighter



Eraser



Activate Stylus Shortcut

Press "Fn + eiP" to activate the stylus shortcut function.
(Red light will flash once to indicate successful activation)

※ Only for Notability/Goodnotes

※ After switching apps, you need to press "Fn + eiP" again to activate the shortcut function

Backlight Function

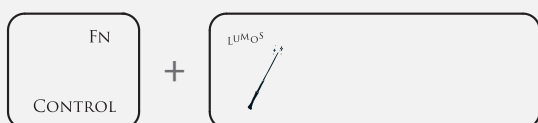

Press Fn + Lumos
(Space Key)



Press Fn + HOGWARTS

Keyboard Charging Guidelines

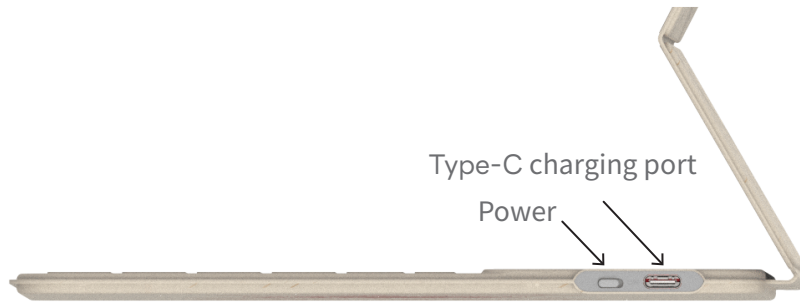

- The Maglite Keyboard Case uses a Type-C charging port. Please ensure that the input voltage does not exceed DC-5V to avoid damaging the keyboard.
- When charging, please connect the Type-C end to the keyboard and the USB end to the charger or power source for charging.
- Before the first use, it is recommended to charge for at least 3 hours before using, and thereafter, charge for at least 2 hours each time.
- Charging from 0% to 100% requires approximately 3 hours.
- If the keyboard becomes hot during charging, please stop charging immediately.
- After fully charging, please unplug the power source as soon as possible. Prolonged overcharging may affect battery life.

Safety Precautions

- Avoid placing in high temperatures, humidity, areas with strong static electricity, strong magnetic fields, or using in such environments.
- Do not strike, throw, apply heavy pressure, or handle the product violently, as this may damage the internal circuit board, rendering the product unusable.
- Keep away from items that generate microwaves, such as microwave ovens.
- For your safety, keep your hands dry and do not plug or unplug the device with wet hands.
- Do not use the product if it has come into contact with water or is dirty.
- Please do not disassemble and repair by yourself.

Tech Specs

Work Voltage	5V
Work Current	≤ 3 mA
Standby Current	≤ 0.1 mA
Sleep Current	≤ 0.02 mA
Charging Current	515 mA
Standby Duration	2000 hr
Charging Duration	3 hr
Charging Interface	Type-C USB
Bluetooth Name	eiP Maglite Keyboard
Actuation Distance	1.5 mm
Auto-Sleeping Time	15 min
Battery Capacity	500 mAh
Working	250 hr
Temperature	-10~50°C

What's in the box

- Maglite Keyboard *1
- USB-C Charging Cable *1
- Card for Manual & First-time Setting

Contact Us

Lemeng Limited Company

Website: www.eipstore.com

Email: service-us@lemeng.com.tw